

# OVERVIEW (600)

## GENERAL

### SYSTEM DESCRIPTION

The engine management system (EMS) controls the following main systems:

- Ignition system
- Rotax Electronic Reverse (RER™)
- Starting system (**electric start models**)
- Digitally Encoded Security System (D.E.S.S.).

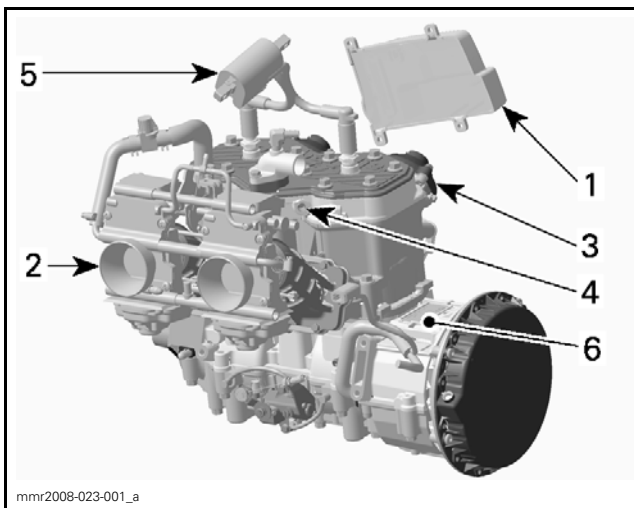

1. Engine control module (ECM)
2. TM carburetors
3. RAVE valves
4. Coolant temperature sensor (CTS)
5. Ignition coil
6. Trigger coils (2)

The EMS also offers a monitoring system and diagnostic mode to help troubleshoot some problems. Refer to *DIAGNOSTIC AND FAULT CODES* subsection.

### Engine Control Module (ECM)

The engine control module (ECM) is the brain of the engine management system.

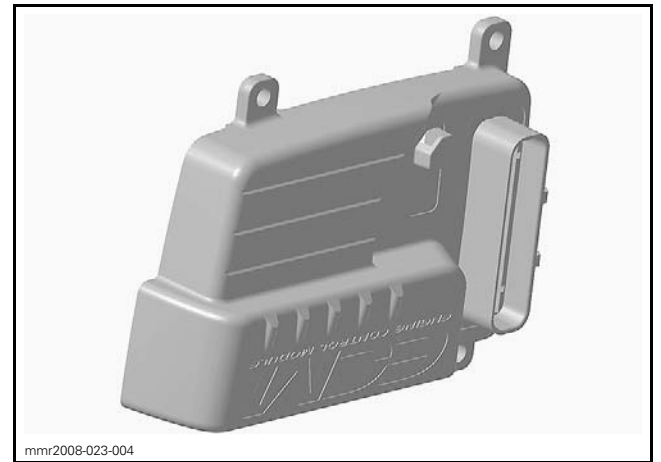
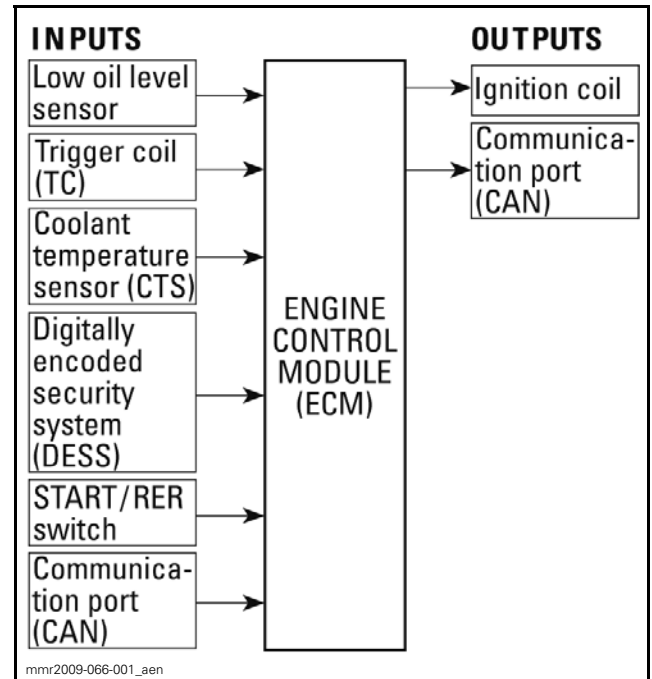

ECM

The ECM and the multifunction gauge communicate together through the CAN lines (Controller Area Network).

The ECM is located under the hood, on the oil injection tank.

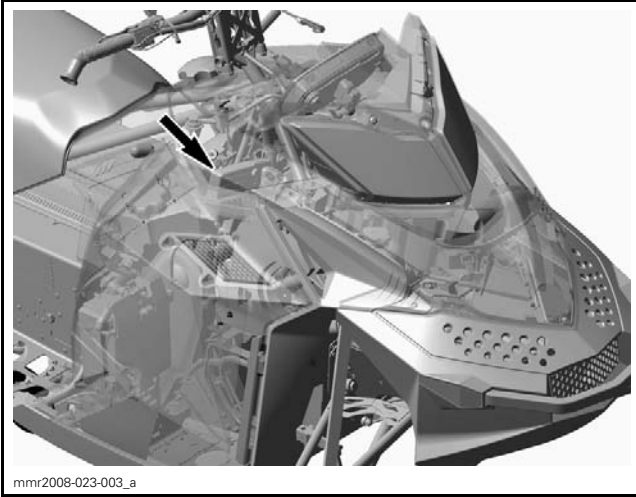

**NOTE:** To test the ECM, refer to *IGNITION SYSTEM* subsection.

### Engine RPM Limiter

The ECM will limit the maximum engine speed to approximately 8600 RPM.